

INDUSTRIAL NETWORK SOLUTIONS > FOR REMOTE ACCESS

Enabled by MBConnect

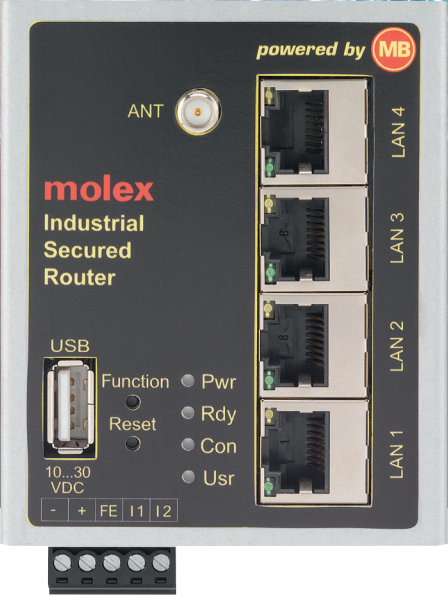

molex

**REMOTE ACCESS SOLUTIONS >
FOR INDUSTRIAL
APPLICATIONS**



**Bringing People, Processes
and Technology Together.**



Sophisticated Design
and Functionality,
Simplified
Configuration,
Deployment and
Operation.

- Designed to be easily configured and operated without IT expertise.
- Effectively communicate to remote machines and control systems.
- Direct connection to machines and control systems without modifying existing network configurations.
- Integrated firewall. The only incoming connection is from the server and no other sources.
- Secure VPN connection, pre-shared keys, SSL encryption, and two-factor authentication.
- Security validated by a BSI certification company with annual audits.

INDUSTRIAL REMOTE ACCESS SOLUTIONS > FOR COMPLETE NETWORK CONNECTIVITY

Industrial Cloud Servers

Configure, manage and access automation systems and perform remote operations through audited, cyber secure connections using a public or private cloud server.

- Partnered with MConnect to provide a platform and portal for secure remote access via the internet.
- Easy configuration, no IT expertise required.
- Centralized Management - all-in-one portal application (device, user management, connections, alarms, dashboard...).
- OPEN VPN security validated by Secuvera, a BSI-certified company.
- Two-factor authentication.
- Secure remote password protocol.
- Scalable, runs on private (your cloud server runs under the control of your IT) or public (ready-to-use server).

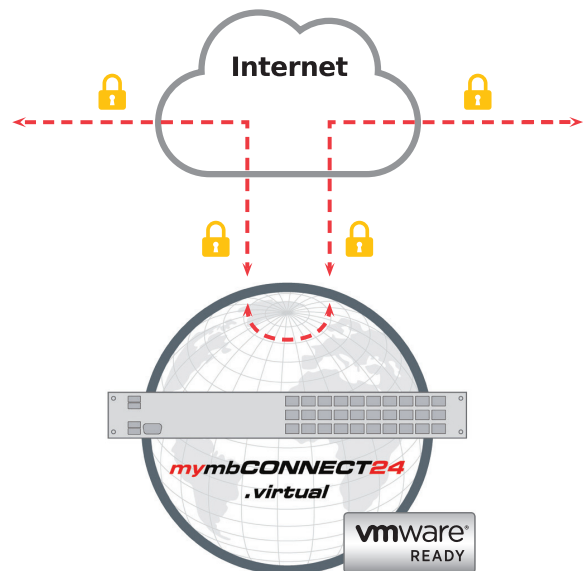



Industrial Remote Access Ecosystem

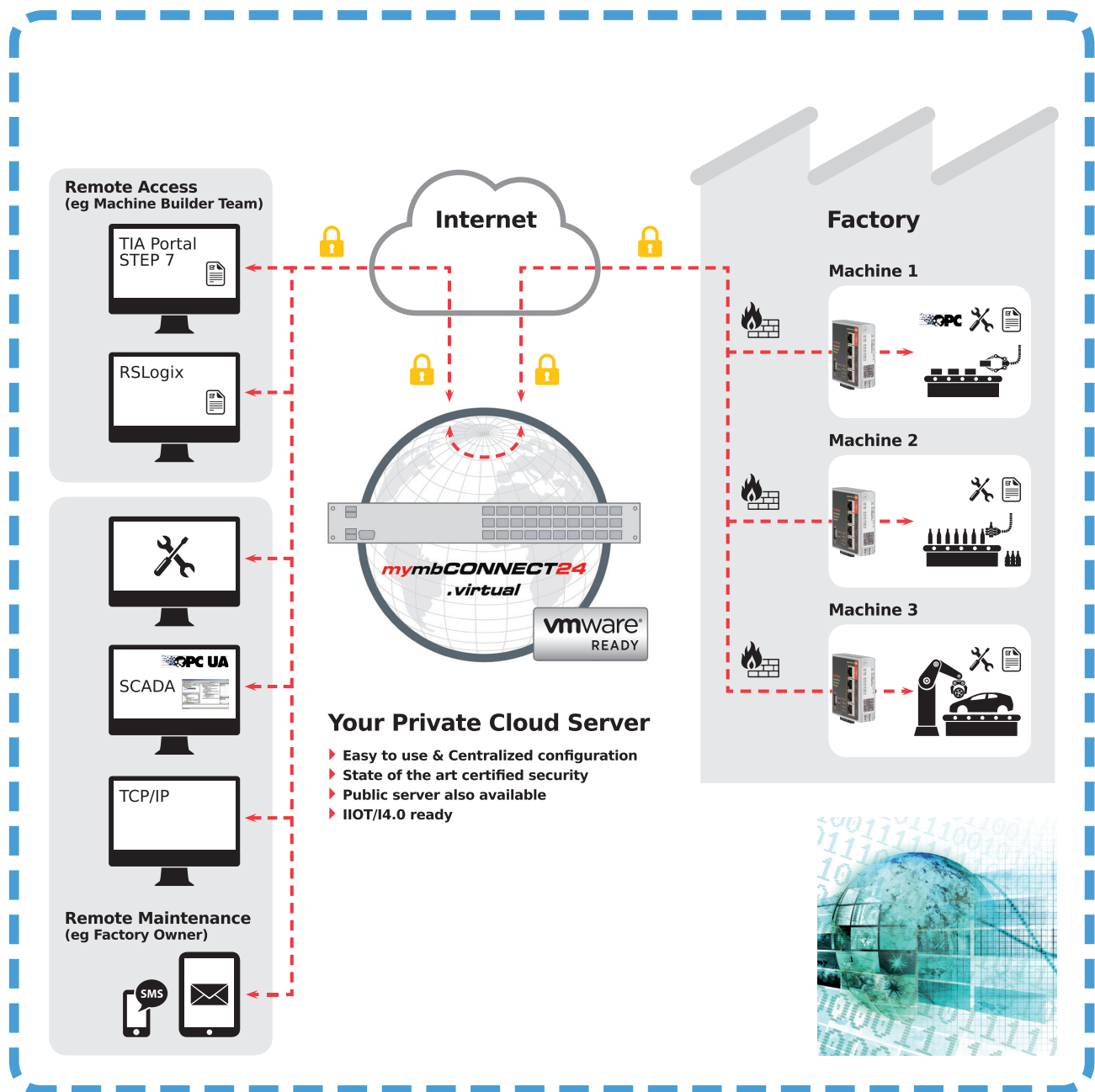

INDUSTRIAL REMOTE ACCESS SOLUTIONS > FOR COMPLETE NETWORK CONNECTIVITY

Moxel Industrial Secured Routers provide a firewalled, seamless integration of a machine into a factory network through cyber-secured remote access, while still designed to be easily setup and operated without needing IT expertise.

Features and Benefits

Own your own server

No dependence on third-party services.
You own the network!

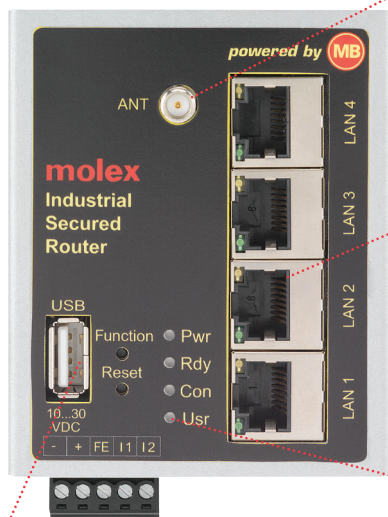

User-Friendly

Easy configuration, no IT skills required. USB over Ethernet

Wi-Fi interface for VPN

Use of existing internet connection thru Wifi
Secured with easy-to-use firewall

4-port Ethernet Switch

Allow integration without modifying IP configuration using NAT
No need for additional switch

Diagnostic LEDs

Status and troubleshooting made easy with LEDs for power, server connection status and operation status

Mobile-device friendly

Works easily on mobile devices and other hardware

WAN Interface for VPN

Use of existing internet connection
Secured with easy-to-use firewall

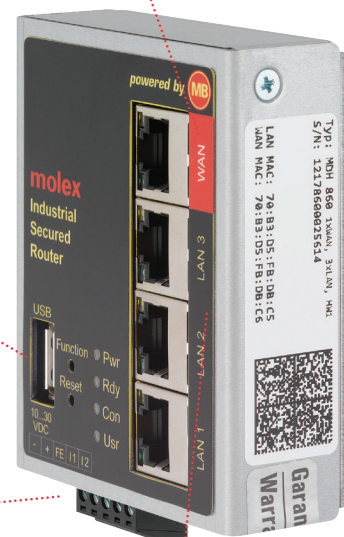

USB Connector

Easy configuration
USB over Ethernet

2 digital inputs

Allows alarm notification.
Allows routing functions to be switched off

3-port Ethernet Switch

Allows integration without modifying IP machine configuration using NAT. No need for additional switch



Specifications - Routers

Interfaces

Order No.	112036-5100	112036-5101	112036-5102	112036-5103	112036-5104	Characteristics
Engineering No.	DRL-ISR-100	DRL-ISR-101	DRL-ISR-103	DRL-ISR-103	DRL-ISR-104	
USB Interface	1x	1x	1x	1x	1x	USB Host 2.0
Digital Inputs	2x	2x	2x	2x	2x	10 – 30V DC
Switch Port	3x	4x	4x	4x	4x	10/100Mb FD auto-negotiation
WAN Interface	1x					10/100 Mbit/s full and half duplex operation, auto-crossing
RP-SMA Socket					1x	1 antenna included
Wi-Fi Modem					1x	IEEE802.11b/g/n
3G Modem		1 x UMTS				850, 900,1800,1900Mhz
4G Modem			1 x LTE	1 x LTE		DRL-ISR-102: 900, 1800Mhz DRL-ISR-103: 850, 1800Mhz

General Information

Voltage	10 - 30V DC (SELV and limited-energy circuit)
Power consumption	max. 250mA @ 24V DC
IP protection class	IP 20
Operating temperature	-40 – 75°C (0 – 50° for DRL-ISR-104)
Storage temperature	-40 – 85°C
Humidity	0 – 95% (non-condensing)
Dimensions (max.)	69mm x 38.5 x 92.5mm (W x D x H)
Weight (max.)	240g
Mounting	DIN rail mounting (based on DIN EN 50022)
EMC	EN 61000-6-4:2011-9; EN 61000-6-2:2006-3
Regulatory approvals	CE, UL, FCC, RoHS, RoHS China, REACH, EN 60950-1:2014-08; ETSI EN 300 328 V1.8.1 (2012-06), EN 60950-1 :2014-08, EN 60950-1:2014-08; ETSI EN 300 328 V1.8.1 (2012-06)

Markets Served

Food and Beverage



Robotics



Oil and Gas



www.molex.com

molex

Molex is a registered trademark of Molex, LLC in the United States of America and may be registered in other countries; all other trademarks listed herein belong to their respective owners.

Order No. 987651-8183

©2018 Molex