

Pneumatic Universal Crimp Machine

molex[®]

Molex Pneumatic Universal Crimp Machine enables fast crimping, reduces error and provides flexibility with interchangeable heads

Features and Benefits

Operated with a foot pedal	Reduces operator fatigue and error
Faster termination compared to manual hand tool	Speeds up manufacturing processes
Interchangeable head	Terminates a wide range of wires. Offers production flexibility
Crimp heads and die sets can be used with legacy Molex hand tools	Provides cost savings when converting from hand tools. Accommodates workload and environmental changes for efficient and fast tool replacements
Transparent safety guard	Offers operator protection



Molex Pneumatic Universal Crimp Machine

Applications

- Industrial
- Commercial Vehicle
- Automotive
- Consumer / Home Appliance



Consumer Appliance



Industrial

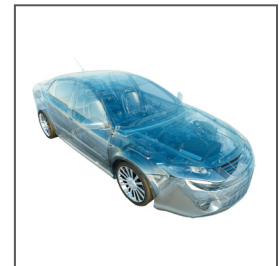

Automotive

Pneumatic Universal Crimp Machine



Specifications

MECHANICAL

Stroke (min.): 6.00mm
 Stroke (max.): 32.00mm
 Crimp Force at 6 bar: 75 kN
 Noise Level: 69 dB (A)
 Weight Including Foot Pedal (approx.): 60kg (132 lbs.)

Air Pressure (max.): 6 bar/87 psi
 Air Consumption at a Stroke of 32.00mm: 55 l
 Air Consumption at a Stroke of 10.00mm: 17.1 l

PHYSICAL

Length: 540.00mm
 Width: 263.00mm
 Height (without eyebolt): 515.00mm
 Height (with eyebolt): 555.00mm

Ordering Information

Order No.	Description	Accessories
63801-8900	Pneumatic Universal Crimp Machine	Crimp Adapter for DIN-Style Dies (63801-8901)
		Crimp Adapter for 35.00mm-Wide U-Dies (63801-8902)
		Crimp Adapter for 22.00mm-Wide U-Dies (63801-8903)

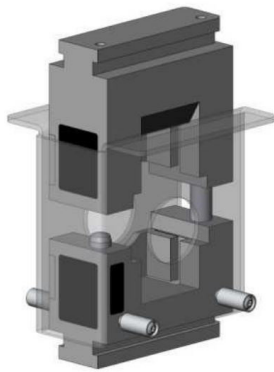

Crimp Adapter for DIN-Style Dies (63801-8901)

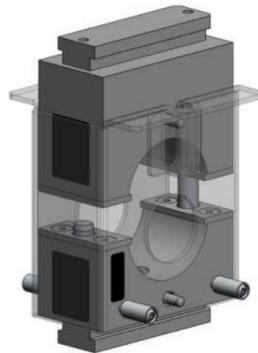

Crimp Adapter for 35.00mm-Wide U-Dies (63801-8902)

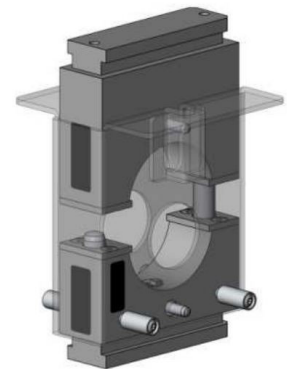

Crimp Adapter for 22.00mm-Wide U-Dies (63801-8903)

www.molex.com/applicationtooling

Molex is a registered trademark of Molex, LLC in the United States of America and may be registered in other countries; all other trademarks listed herein belong to their respective owners.